



Section II

2) a) \* Create petitions <sup>potential (targeted)</sup> for users such as surveys, interviews, etc in order to identify the main objective goals in constructing a software solution, in order to please the public and make a profit.

\* Allow real users to test products capabilities in the real world before introducing it to the market place. This is important, because it ensures ~~that~~ and test how can the software solution can cope with real test data (that could not have been manufactured in the initial test data) to ensure as little bugs as possible on the computer and thus allows developers to widen hardware capabilities.

b) \* Encourage employees to work more efficiently by improving working conditions such as seating, lighting, comfort, etc; and please the workers by giving them a prize to lighten the employees moral.

\* Increase the standard proposed time it needed to create the product in order to let the employees

-> structured Approach

- Prototype

- Create surveys, interviews, etc to identify product's objective goals in constructing software solution

- Create test data and I/O charts, Data flow diagrams etc to understand the users

---

= encourage  
highlight  
more

play  
work  
plans

denial, optical  
better working conditions

- increase time length to produce projects



work at more ease.

c) i)

Input	Process	Output
reserve room	finds what room	Issues bill to guest
issue payment	is available	Issues <del>an</del> receipt to
	issue how much money	guest
	is needed	gives issued room to
		guest

ii) see next page. →

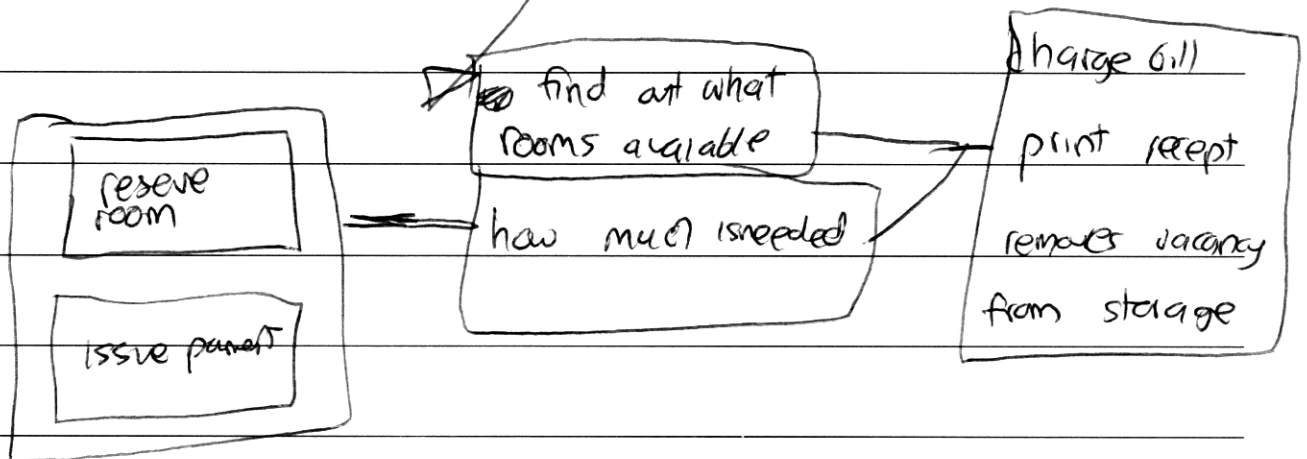

i)

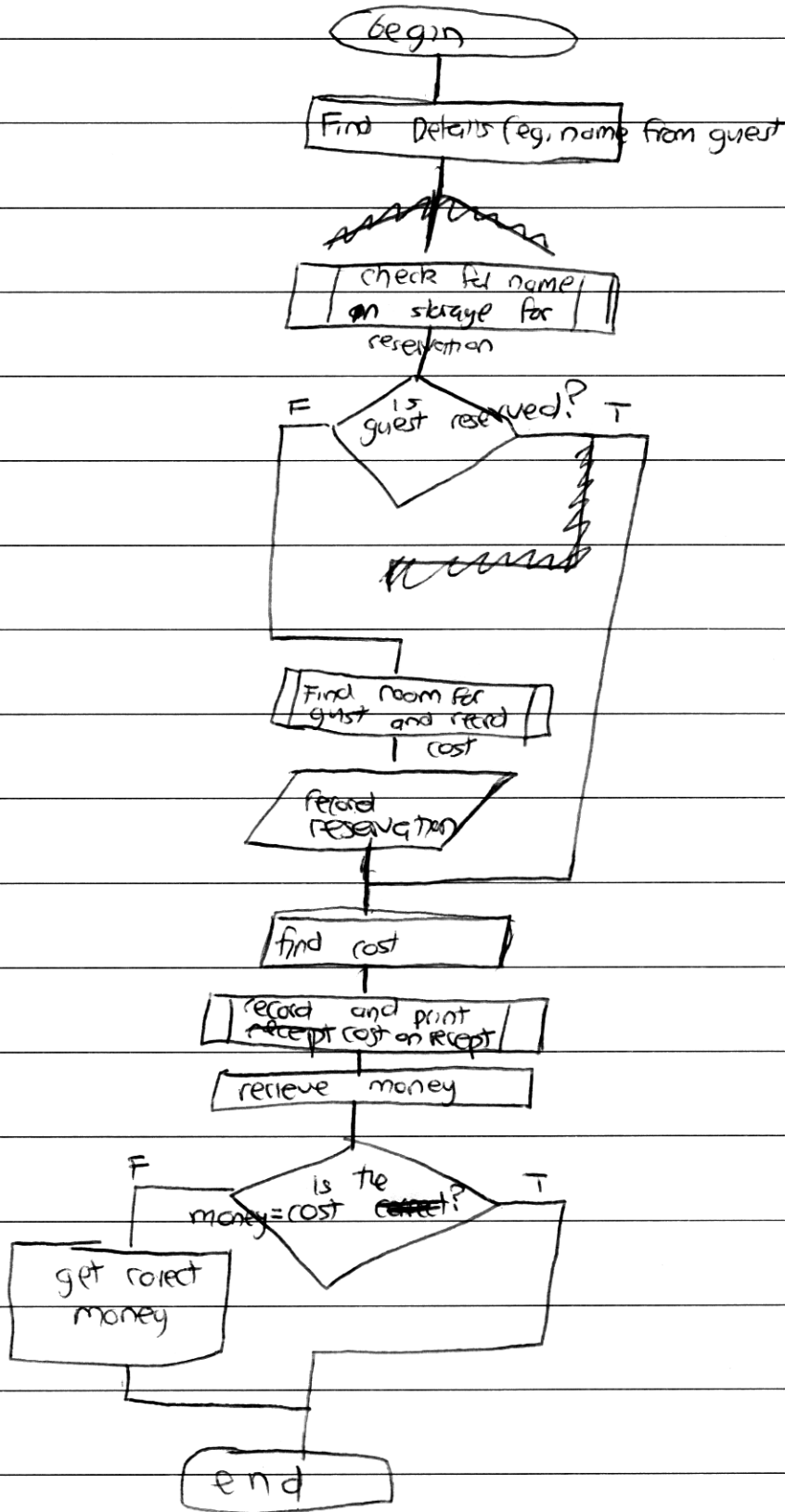

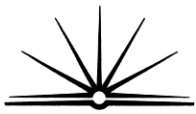

ii) \* The employees may assist you by giving the system analysis step-by-step instructions on how they processed the proceedings via their old system.

\* They may allow you to make a copy of the old system (from the computer) and compile the programing to understand its workings in assembler code to create a clear understanding of its process.